

ACCESSORIES / ACCESSOIRES / ZUBEHÖR

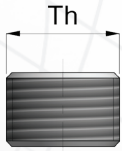

■ PRESSURE PLUGS / BOUCHON FILETÉ / VERSCHLUßTOPFEN



Th (BSPT)	Part-number	
	BRASS (water)	STEEL (oil)
1/8	PB18	PA18
1/4	PB14	PA14
3/8	PB38	PA38
1/2	PB12	PA12
3/4	PB34	PA34
1"	PB100	PA100



1- DIN 906 - Material / Matière: MS 58 (Brass / Laiton / Messing)
2- DIN 906 - Material / Matière: Steel / Acier / Stahl

■ PRESSURE PLUGS / BOUCHON FILETÉ / VERSCHLUßTOPFEN

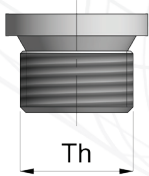

Th (G)	Part-number	
	BRASS (water)	STEEL (oil)
1/8	HP18BC	HP18AC
1/4	HP14BC	HP14AC
3/8	HP38BC	HP38AC
1/2	HP12BC	HP12AC
3/4	HP34BC	HP34AC
1"	HP100BC	HP100AC

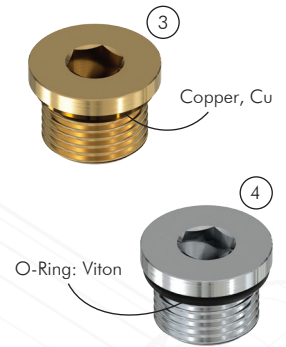

3- DIN 908 - Material / Matière: MS 58 (Brass / Laiton / Messing) + Copper Washer / Rondelle de Cuivre / Kupferscheibe
4- DIN 908 - Material / Matière: Steel / Acier / Stahl + Seal / Joint / Dichtung: Viton (FPM)

■ THREADLESS PRESSURE PLUG / BOUCHON DE PRESSION NON FILETÉ VERSCHLUßSTOPFEN OHNE GEWINDE

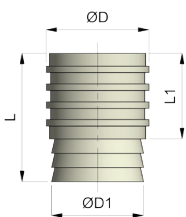

ØD	ØD1	L	L1	Part-number
8	M4	11	8	P8E
10	M6	14	10	P10E
12	M6	15	10	P12E
16	M8	16	12	P16E

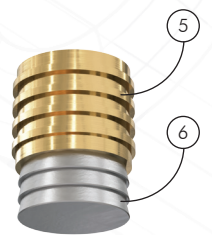

5- Material / Matière: MS 58 (Brass / Laiton / Messing)
6- Material / Matière: Stainless Steel / Acier Inoxydable / Edelstahl

■ THREADLESS PRESSURE PLUG / BOUCHON DE PRESSION NON FILETÉ VERSCHLUßSTOPFEN OHNE GEWINDE

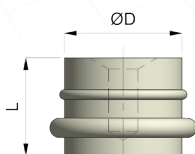

ØD	L	Part-number
8	10	P8W
10	10	P10W
12	10	P12W
16	12	P16W

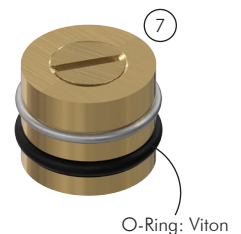

7- Max. Temp: 200 °C - Material / Matière: MS 58 (Brass / Laiton / Messing) + Seal / Joint / Dichtung: Viton (FPM)